



# How to Fix Analog Drift for the SCUF IMPACT

SCUF IMPACT - PLAYSTATION 4 CONTROLLERS The...

Written By: Amirparsa Monshi



# INTRODUCTION

## SCUF IMPACT - PLAYSTATION 4 CONTROLLERS

The instructions apply to all PLAYSTATION 4 SCUF controllers. Sway in analogs are caused by either damage to the controller or when the controller sensors are dirty. This problem will affect aiming when using the controller and the experience is not so fun. If the controller is in the good condition and you still have the sway in your analog(s), use the guide and follow the steps in order to fix the sway in your analog(s). The guide is pretty simple and there is no need for any special tools.

### TOOLS:

[Tweezers](#) (1)

[High Content Rubbing Alcohol](#) (1)

[Q-Tips](#) (1)

## Step 1 — How to Fix Analog Drift for the SCUF IMPACT



- Unlock the L3 or R3 ring by turning it counter clockwise.
- Remove the L3 or R3 ring.

## Step 2



- Pull the analog gently in order to get it out.



### Step 3



- Use a tweezer tip to gently open the green box.

### Step 4

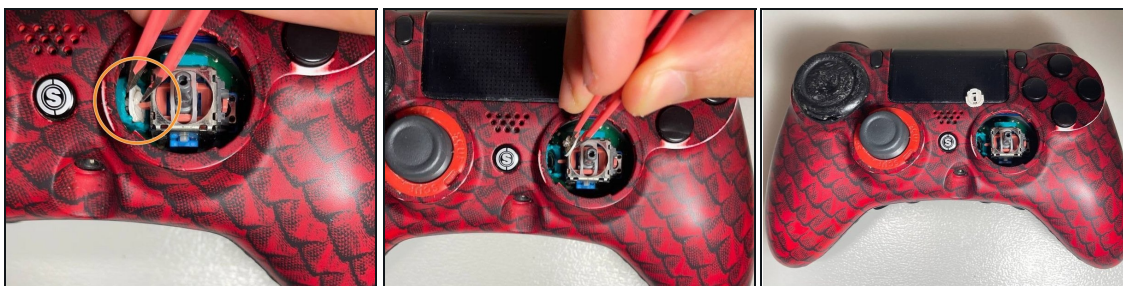

- Locate the sensor in the green box and take it out slowly.

### Step 5

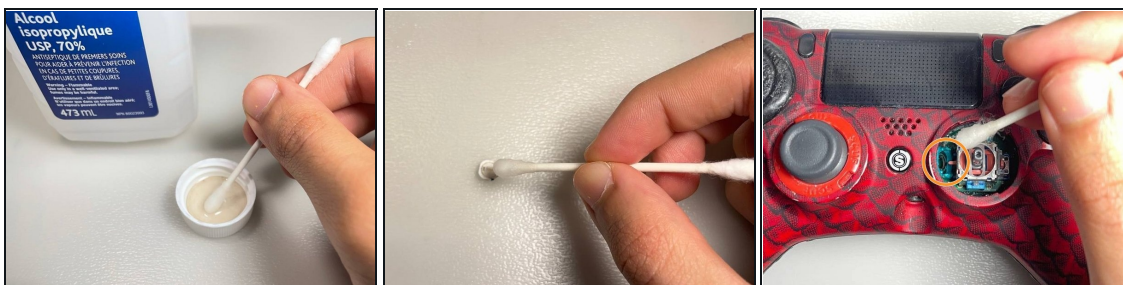

- Dip the q-tip in rubbing alcohol to clean the sensor and inside the green box for any dust or dirt.

## Step 6



 Place the sensor back in the box. To reassemble your controller, follow the instructions 1-4 in reverse order.

---

To reassemble your device, follow these instructions in reverse order.