



# Ford Focus Radio Suppression Capacitor Replacement

This guide shows how to replace the radio suppression capacitor in a 2007 Ford Focus.

Written By: Amin Sadessi



## INTRODUCTION

We will demonstrate how to remove the radio suppression capacitor in a 2007 Ford Focus and replace it with a new capacitor by using a ratcheting screwdriver and 8mm nut driver attachment.

The radio suppression capacitor acts as a noise barrier as it dampens engine noise in the cabin of the vehicle. However, sometimes the wire in the capacitor corrodes and fails to dampen noise from the engine. Additionally, the wire may come loose, blowing fuses or even the battery.



### TOOLS:

- [8mm socket](#) (1)
- [ratcheting screw driver](#) (1)
- [10mm Wrench](#) (1)
- [Safety Glasses](#) (1)
- [Nitrile Gloves 100 Box](#) (1)



### PARTS:

- [Radio Suppression Capacitor](#) (1)

## Step 1 — Radio Suppression Capacitor



- Pop the hood of the 2007 Ford Focus using the pull lever under the steering wheel.
- Secure the hood with the hood prop on the left side of the engine.

## Step 2



- To disconnect the battery follow steps 2-4.
  - Loosen the bracket with the wrench.
  - Remove the top cover.



### Step 3



**⚠ You should wear protective gloves and goggles/glasses when working with the battery.**

- Remove the negative cable (usually black in color and labeled - or "Negative" ) by turning the nut clockwise with the wrench.

**⚠ Set the ground cables away from the battery to avoid electrocution.**

### Step 4



- Remove the positive cable (usually red in color and labeled with + or "Positive")by turning the nut clockwise with the wrench.



## Step 5



- Unscrew the first anchor bolt that attaches the metal clip to the engine mount.

**i** Replace the anchor bolt if corroded.

## Step 6

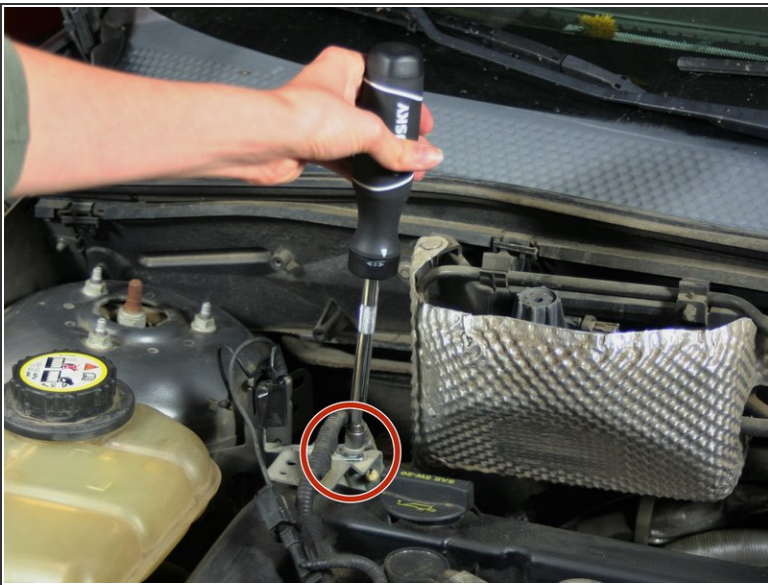

- Unscrew the second anchor bolt that secures the metal mount.

## Step 7

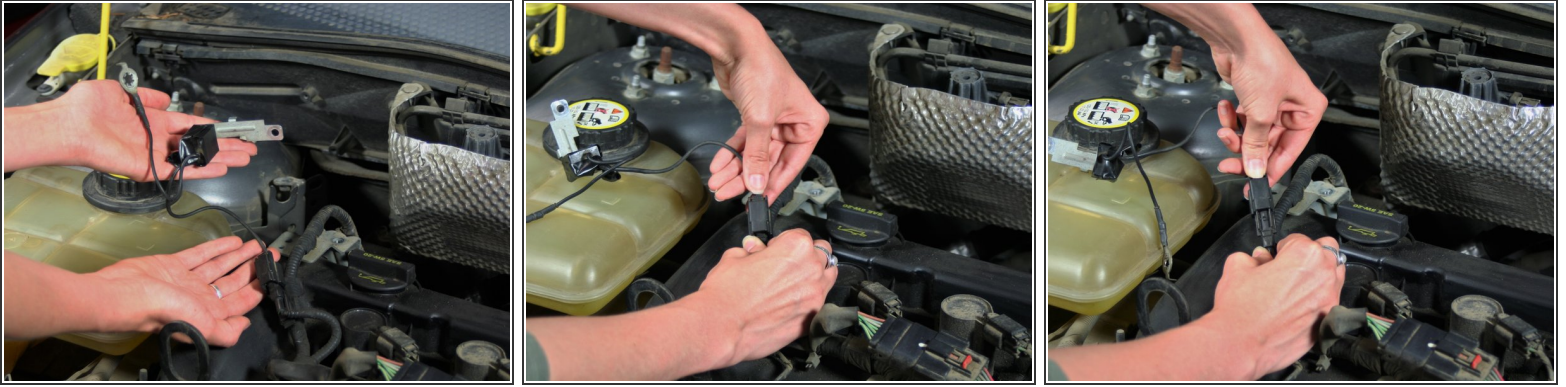

- Detach the wiring harness by holding down the tab on the top of the clip.
- Pull apart.

## Step 8



- Obtain the new capacitor and reattach it by reversing the same steps you followed to disconnect the old capacitor.

Install the new capacitor by following the steps above in reverse order.